



## PP STEEL FLANGE



### VERSION

- PP-GF30 black (30% glass-fiber reinforced) with steel core
- UV-resistant; usable in outdoor installations
- connecting dimension: ISO 7005; EN1092; DIN 2501
- bolt circle PN10

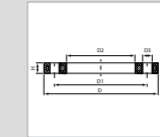

ART. CODE	d	DN	PN	D	D1	D2	D3	H	NXD	TYPE
9.71.020	20	15	16	95	65	28	14	12	4x12	•
9.71.025	25	20	16	105	75	34	14	12	4x12	•
9.71.032	32	25	16	115	85	42	14	16	4x12	•
9.71.040	40	32	16	140	100	51	18	16	4x16	•
9.71.050	50	40	16	150	110	62	18	18	4x16	•
9.71.063	63	50	16	165	125	78	18	18	4x16	•
9.71.075	75	65	16	185	145	92	18	18	8x16	•
9.71.090	90	80	16	200	160	108	18	20	8x16	••
9.71.091	90	80	16	200	160	110	18	20	8x16	•••
9.71.110	110	100	16	220	180	128	18	20	8x16	••
9.71.111	110	100	16	220	180	133	18	20	8x16	•••
9.71.125	125	100	16	220	180	135	18	20	8x16	••
9.71.126	125	125	16	250	210	150	18	24	8x16	•••
9.71.140	140	125	16	250	210	158	22	24	8x16	••
9.71.141	140	125	16	250	210	167	18	24	8x16	••
9.71.160	160	150	16	285	240	178	22	24	8x20	••
9.71.180	180	150	16	285	240	188	22	24	8x20	••
9.71.200	200	200	16	340	295	235	22	27	8x20	••
9.71.225	225	200	16	340	295	238	22	27	8x20	••
9.71.250	250	250	16	395	350	288	22	30	12x20	••
9.71.280	280	250	16	395	350	294	22	30	12x20	••
9.71.315	315	300	16	445	400	338	22	34	12x20	••
9.71.355	355	350	16	515	460	376	23	40	16x20	••
9.71.400	400	400	16	574	515	430	26	40	16x24	••

- Socket -and But Fusion
- But Fusion
- Socket Fusion

## THE POWER OF THE COMBINATION



For years, Van de Lande is specialized in injection moulding PVC-U fittings and valves. The expertise gained in the field of PVC-U has been used later in our PVC-C program and is now being used again in a new field of application.

From now on, high-quality Flange Adaptors are also available in PE100, which are subjected to strict visual and functional checks like the rest of the Van de Lande program.

This results in a distinctive PE100 product with excellent dimensioning. Of course, our PE100 products meet the highest quality requirements.

We call it The Quality Standard.

## PE FLANGE ADAPTOR



- UV-resistant
- high chemical resistance

### VERSION

- grooved sealing surface
- available in SDR11 and SDR17
- range 20 up to 225mm
- dimensions and pressure testing according to EN12201, EN15555 and EN16494



## RUBBER WASHER FOR FLANGE ADAPTOR



To be used in combination with a PE100 Flange Adaptor.

### VERSION

- EPDM

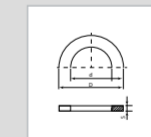

EPDM

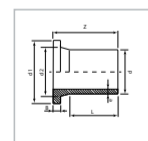

PE 100

ART. CODE	d	L	Z	e	B	d1	d2
SDR11							
5119702000	20	65	89	2	7	45	27
5119702500	25	64	89	2,3	9	58	33
5119703200	32	63	89	3	10	68	40
5119704000	40	64	92	3,7	11	78	50
5119705000	50	78	108	4,6	12	88	61
5119706300	63	87	123	5,8	14	102	74
5119707500	75	89	127	6,8	16	122	88
5119709000	90	102	142	8,2	17	138	103
5119711000	110	121	162	10	18	158	122
5119712500	125	123	172	11,4	25	158	129
5119714000	140	131	183	12,7	25	188	152
5119716000	160	144	200	14,6	25	212	175
5119718000	180	142	201	16,4	30	212	184
5119720000	200	137	204	18,2	32	268	225
5119722500	225	141	207	20,5	32	268	235

ART. CODE	d	L	Z	e	B	d1	d2
SDR17							
5119706301	63	87	123	3,8	14	102	74
5119707501	75	89	127	4,5	16	122	88
5119709001	90	102	142	5,4	17	138	103
5119711001	110	121	162	6,6	18	158	122
5119712501	125	123	172	7,4	25	158	129
5119714001	140	131	183	8,3	25	188	152
5119716001	160	144	200	9,5	25	212	175
5119718001	180	142	201	10,7	30	212	184
5119720001	200	137	204	11,9	32	268	225
5119722501	225	141	207	13,4	32	268	235

ART. CODE	Size	DN	D	d	S	ART. CODE	Size	DN	D	d	S
SDR 11						SDR17					
5880402000	20	15	51	16	3	5880406301	63	50	107	58	3
5880402500	25	20	61	22	3	5880407501	75	65	127	69	3
5880403200	32	25	71	28	3	5880409001	90	80	142	84	3
5880404000	40	32	82	34	3	5880411001	110	100	162	100	3
5880405000	50	40	92	42	3	5880412501	125	125	162	114	3
5880406300	63	50	107	53	3	5880414001	140	125	192	127	3
5880407500	75	65	127	63	3	5880416001	160	150	218	146	3
5880409000	90	80	142	76	3	5880418001	180	175	218	164	3
5880411000	110	100	162	93	3	5880420001	200	200	273	181	3
5880412500	125	125	162	105	3	5880422501	200	200	273	203	3
5880414000	140	125	192	117	3						
5880416000	160	150	218	135	3						
5880418000	180	175	218	151	3						
5880420000	200	200	273	168	3						
5880422500	225	200	273	188	3						

**THE QUALITY STANDARD SINCE 1956**