

Adapter nipple (parts)

Draadeind
Gewindestück
Collet d'union fileté
Adattore a filetto
Nipple adaptador

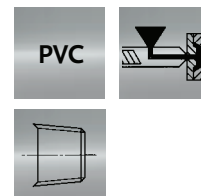
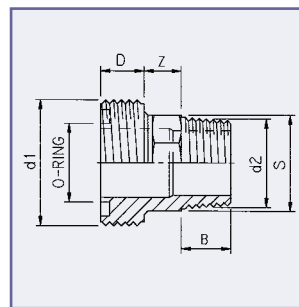

Art.code	d1	d2	Z	B	D	S	O-ring	Quantity
8.24.012	5/8" (M)	1/4" (M)	14	12	10	23	12.37x2.62	50
8.24.016	3/4" (M)	3/8" (M)	15	12	11	25	15.55x2.62	50
8.24.020	1" (M)	1/2" (M)	17	16	12	28	20.22x3.53	50
8.24.025	1 1/4" (M)	3/4" (M)	18	17	12	32	28.17x3.53	50
8.24.032	1 1/2" (M)	1" (M)	18	21	14	38	32.92x3.53	50
8.24.040	2" (M)	1 1/4" (M)	19	24	16	46	40.64x5.33	25
8.24.050	2 1/4" (M)	1 1/2" (M)	19	24	18	55	46.99x5.33	25
8.24.063	2 3/4" (M)	2" (M)	20	28	20	65	59.69x5.33	25
8.24.075	ZGTD	2 1/2" (M)	21	34	30	94	78.74x5.33	10
8.24.090	ZGTD	3" (M)	25	37	35	114	97.79x5.33	5
8.24.110	ZGTD	4" (M)	28	43	40	138	117.5x5.33	5

Union nut (parts)

Wartelmoer
Überwurfmutter
Écrou de raccord
Ghiera
Tuerca de enlace

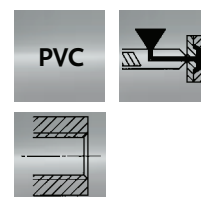
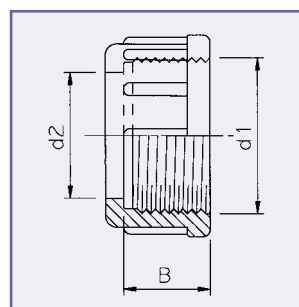

Art.code	Dia	d1	d2	B	Quantity
8.20.010	10/12	5/8" (F)	18	14	50
8.20.016	16	3/4" (F)	22	16	50
8.20.020	20	1" (F)	27	16	50
8.20.025	25	1 1/4" (F)	36	19	50
8.20.032	32	1 1/2" (F)	41	19	50
8.20.040	40	2" (F)	53	22	25
8.20.050	50	2 1/4" (F)	60	24	25
8.20.063	63	2 3/4" (F)	75	29	25
8.20.075	75	ZGTD" (F)	90	39	10
8.20.090	90	ZGTD (F)	108	44	5
8.20.110	110	ZGTD" (F)	130	49	5