

Locking Unit Type IS

Series IS4

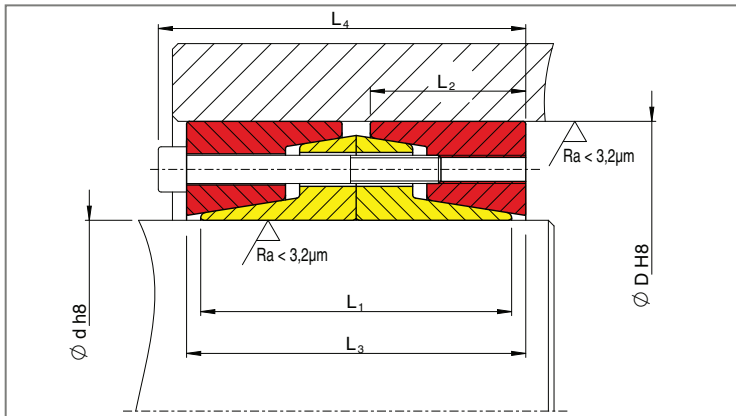

Code:

- M_t maximum transmissible torque of a shrink disc with $P_{ax}=0$
- P_{ax} maximum transmissible axial load of a shrink disc with $M_t=0$
- M_a required tightening torque of the tightening bolts (see also "Mounting and Removal Instructions")
- P_w surface pressure on shaft
- P_n surface pressure on hub

Dimensions L_3 and L_4 apply to untightened units.

Type	d	x	D	M_t kNm	P_{ax} kN	L_1 mm	L_2 mm	L_3 mm	L_4 mm	B*	M_a Nm	P_w N/mm ²	P_n	kg
IS 4	30	x	55	0,9	60	40	17	46	52	6 x M6	17	132	85	0,5
IS 4	35	x	60	1,2	71	40	17	46	52	7 x M6	17	135	93	0,6
IS 4	40	x	65	1,5	75	40	17	46	52	8 x M6	17	125	90	0,6
IS 4	45	x	75	2,5	111	48	20	56	64	6 x M8	41	136	98	1,1
IS 4	50	x	80	3,0	120	48	20	56	64	7 x M8	41	133	100	1,1
IS 4	55	x	85	3,8	138	48	20	56	64	8 x M8	41	139	108	1,2
IS 4	60	x	90	4,3	143	48	20	56	64	8 x M8	41	132	106	1,3
IS 4	65	x	95	5,3	163	48	20	56	64	9 x M8	41	139	114	1,4
IS 4	70	x	110	7,6	217	58	24	68	78	8 x M10	83	142	109	2,6
IS 4	75	x	115	8,2	219	58	24	68	78	8 x M10	83	133	105	2,7
IS 4	80	x	120	8,7	217	58	24	68	78	8 x M10	83	124	100	2,8
IS 4	85	x	125	10,4	245	58	24	68	78	9 x M10	83	132	108	3,0
IS 4	90	x	130	12	272	58	24	68	78	10 x M10	83	138	116	3,1
IS 4	95	x	135	13	271	58	24	68	78	10 x M10	83	131	111	3,3
IS 4	100	x	145	16	317	66	28	76	88	8 x M12	145	127	104	4,5
IS 4	110	x	155	19	340	66	28	76	88	9 x M12	145	124	104	4,8
IS 4	120	x	165	23	377	66	28	76	88	10 x M12	145	126	108	5,2
IS 4	130	x	180	29	453	76	33	86	98	12 x M12	145	122	101	7,2
IS 4	140	x	190	32	453	76	33	86	98	12 x M12	145	113	96	7,7
IS 4	150	x	200	40	528	76	33	86	98	14 x M12	145	123	106	8,2
IS 4	160	x	210	45	566	76	33	86	98	15 x M12	145	123	108	8,6
IS 4	170	x	225	53	622	86	38	98	112	12 x M14	230	113	96	11
IS 4	180	x	235	65	726	86	38	98	112	14 x M14	230	124	108	12
IS 4	190	x	250	79	829	102	46	114	128	16 x M14	230	114	96	17
IS 4	200	x	260	93	933	102	46	114	128	17 x M14	230	121	103	17
IS 4	220	x	285	126	1141	110	50	122	138	16 x M16	355	125	106	22
IS 4	240	x	305	137	1141	110	50	122	138	16 x M16	355	115	99	24
IS 4	260	x	325	167	1284	110	50	122	138	18 x M16	355	119	106	26
IS 4	280	x	355	219	1562	130	60	146	164	18 x M18	485	114	97	38
IS 4	300	x	375	260	1735	130	60	146	164	18 x M18	485	118	102	40
IS 4	320	x	405	357	2230	154	72	170	190	18 x M20	690	120	101	58
IS 4	340	x	425	379	2230	154	72	170	190	20 x M20	690	113	97	62
IS 4	360	x	455	501	2784	178	84	198	220	18 x M22	930	115	97	85
IS 4	380	x	475	555	2923	178	84	198	220	20 x M22	930	115	97	89
IS 4	400	x	495	585	2923	178	84	198	220	20 x M22	930	109	93	93
IS 4	420	x	515	658	3132	178	84	198	220	22 x M22	930	111	96	97
IS 4	440	x	545	796	3616	202	96	226	250	22 x M24	1200	108	92	128
IS 4	460	x	565	832	3616	202	96	226	250	22 x M24	1200	103	88	134
IS 4	480	x	585	868	3616	202	96	226	250	24 x M24	1200	99	85	139
IS 4	500	x	605	984	3938	202	96	226	250	26 x M24	1200	103	90	144
IS 4	520	x	630	1024	3938	202	96	226	250	25 x M24	1200	99	86	157
IS 4	540	x	650	1063	3938	202	96	226	250	26 x M24	1200	96	84	162
IS 4	560	x	670	1181	4219	202	96	226	250	27 x M24	1200	99	87	168
IS 4	580	x	690	1224	4219	202	96	226	250	27 x M24	1200	96	84	173
IS 4	600	x	710	1266	4219	202	96	226	250	27 x M24	1200	92	82	179

Further sizes on request. Technical changes to be reserved without notice.

* Tightening bolts DIN EN ISO 4762: Grade 12.9 When ordering please state: e.g. IS4x100x145 (Type x Ø d x Ø D)