

Double row ball bearing | Product range

Races made from xirodur® B180

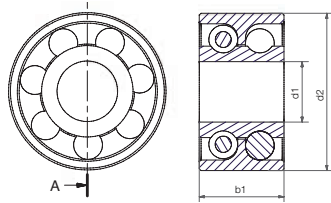

PA cage,
stainless steel balls
or glass balls



Order key

Type xirodur® Options

BB-6000-B180-10-ES-D

Ball bearing	Dimensions acc. to DIN 625-1	Race material	Cage material	Ball material	Double row
--------------	------------------------------	---------------	---------------	---------------	------------

Options:

Cage material

10 = PA

Ball material

ES = stainless steel

GL = glass



- Higher loads
- Less expensive than two comparable bearings

Technical data

Size	Max. stat. bearing load axial [N]	Bearing load		Max. speed [rpm]	Weight	
		stat. [N]	dyn. [N]		ES [g]	GL [g]
6000	800	160	225	850	11.0	7.0
6004	1,100	350	530	510	36.0	29.0

Dimensions [mm]

Inner Ø d1	Outer Ø d2	Width b1	Cage/ball material combination		Part No.
			PA/ES	PA/GL	
10	26	14	●	●	BB-6000-B180-10-ES-D
20	42	20	●	●	BB-6004-B180-10-ES-D



Order example:

BB-6000-B180-10-ES-D = double row ball bearing with PA cage and stainless steel balls

Multi-axis plastic bearing | Product range

Races made from xirodur® B180



PP ball

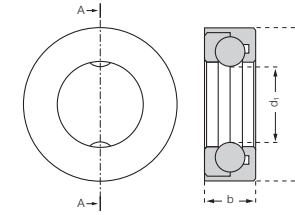

Order key

Type Dimensions xirodur® Ball

BB-MB-1633-11-B180-PP

Ball bearing	Multi-axis bearings	Inner-Ø (d1)	Outer-Ø (d2)	Width (b)	Housing material	Ball material
--------------	---------------------	--------------	--------------	-----------	------------------	---------------

Options:

Housing material

B180 = xirodur® B180

Ball material = PP



- For rotary and linear motions

Technical data

Type	Bearing load, radial		Max. speed [rpm]	Weight PP [g]
	stat. [N]	dyn. [N]		
BB-MB	55	70	500	6,9

Dimensions [mm]

Inner Ø d1	Outer Ø d2	Width b1	Cage/ball material combination	Part No.
			B180/PP	
16.3	33	11	●	BB-MB-1633-11-B180-PP



Order example:

BB-MB-1633-11-B180-10-PP = multi-axis ball bearing with B180 cage and PP balls