

Option steel - pivoting

- For pivoting connections
- One part (two-piece) for all chain widths
- Electrically conductive

Moving end
40400.1

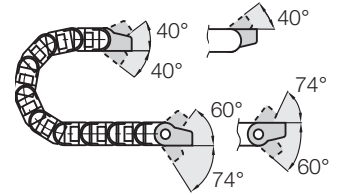

Fixed end
40400.2

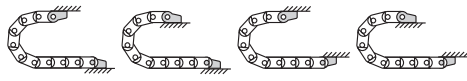

Possible installation conditions -

Further installation angles ► installation sketch

Phone +49- (0) 22 03-96 49-800
Fax +49- (0) 22 03-96 49-222

igus® GmbH
51147 Cologne

Internet: www.igus.eu
E-mail: info@igus.de

Moving end 40400.1 Fixed end 40400.2

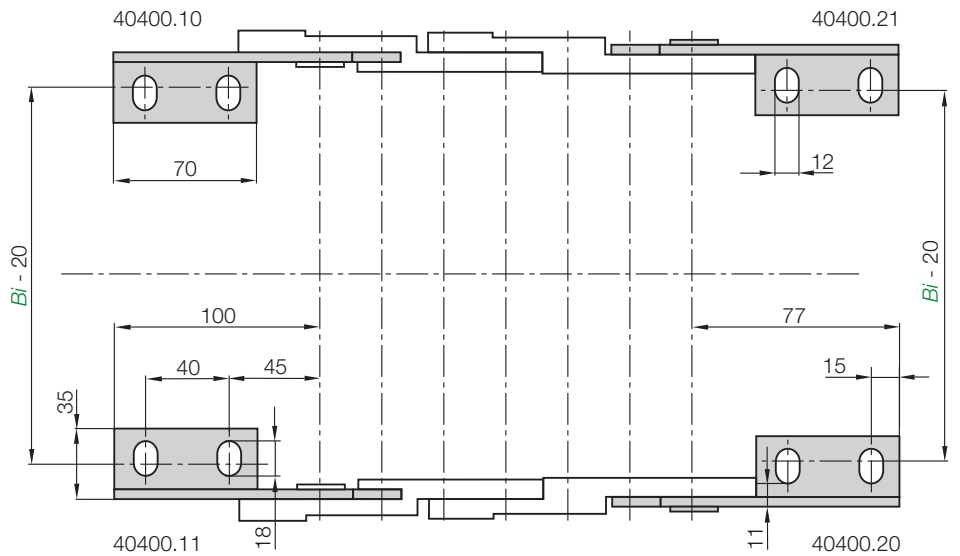

For E-Chain®	Part No. full set	Bi [mm]	For E-Chain®	Part No. full set	Bi [mm]
4040-4140.05	40400.12	50	4040-4140.31	40400.12	312
4040-4140.06	40400.12	65	4040-4140.32	40400.12	325
4040-4140-8840.07	40400.12	75	4040-4140.33	40400.12	337
4040-4140-8840.08	40400.12	87	4040-4140-8840.35	40400.12	350
4040-4140-8840.10	40400.12	100	4040-4140.36	40400.12	362
4040-4140.11	40400.12	112	4040-4140.37	40400.12	375
4040-4140-8840.12	40400.12	125	4040-4140.38	40400.12	387
4040-4140.13	40400.12	137	4040-4140-8840.40	40400.12	400
4040-4140-8840.15	40400.12	150	4040-4140.41	40400.12	412
4040-4140.16	40400.12	162	4040-4140.42	40400.12	425
4040-4140.17	40400.12	175	4040-4140.43	40400.12	437
4040-4140.18	40400.12	187	4040-4140.45	40400.12	450
4040-4140-8840.20	40400.12	200	4040-4140-8840.46	40400.12	462
4040-4140.21	40400.12	212	4040-4140.47	40400.12	475
4040-4140.22	40400.12	225	4040-4140.48	40400.12	487
4040-4140.23	40400.12	237	4040-4140.50	40400.12	500
4040-4140-8840.25	40400.12	250	4040-4140.51	40400.12	512
4040-4140.26	40400.12	262	4040-4140.52	40400.12	525
4040-4140-8840.27	40400.12	275	4040-4140.53	40400.12	537
4040-4140.28	40400.12	287	4040-4140.55	40400.12	550
4040-4140-8840.30	40400.12	300	4040-4140.60	40400.12	600

40400.12 Full set, 4 parts

2 with pin / 2 with bore

Single-part order:

40400.1 Mounting bracket moving end, 1 part left / right

40400.2 Mounting bracket fixed end, 1 part left / right