

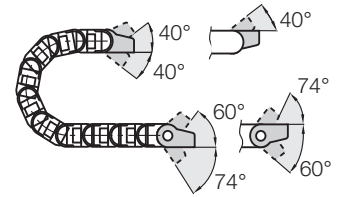

Option steel - pivoting

- For pivoting connections
- One part (two-piece) for all chain widths
- Electrically conductive

Moving end
38380.1



Fixed end
38380.2

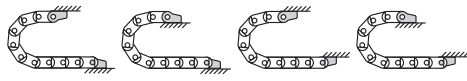

Possible installation conditions -

Further installation angles ► installation sketch

Phone +49- (0) 22 03-96 49-800
Fax +49- (0) 22 03-96 49-222

igus® GmbH
51147 Cologne

Internet: www.igus.de
E-mail: info@igus.de

Moving end
38380.1

Fixed end
38380.2

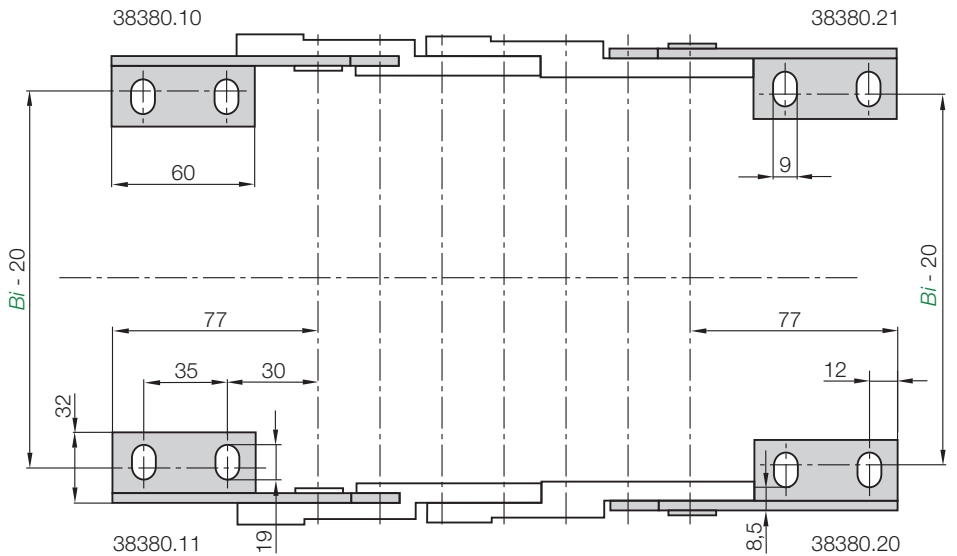

For E-Chain®	Part No. full set	Bi [mm]	For E-Chain®	Part No. full set	Bi [mm]
3838-3938-7838.05	38380.12	50	3838-3938.23	38380.12	225
3838-3938.06	38380.12	68	3838-3938.237	38380.12	237
3838-3938-7838.07	38380.12	75	3838-3938-7838.25	38380.12	250
3838-3938.087	38380.12	87	3838-3938.262	38380.12	262
3838-3938-7838.10	38380.12	100	3838-3938.28	38380.12	275
3838-3938-7838.11	38380.12	108	3838-3938.29	38380.12	287
3838-3938.112	38380.12	112	3838-3938-7838.30	38380.12	300
3838-3938-7838.12	38380.12	125	3838-3938.312	38380.12	312
3838-3938.137	38380.12	137	3838-3938.325	38380.12	325
3838-3938-7838.15	38380.12	150	3838-3938.337	38380.12	337
3838-3938.162	38380.12	162	3838-3938.350	38380.12	350
3838-3938-7838.17	38380.12	168	3838-3938.362	38380.12	362
3838-3938.18	38380.12	175	3838-3938.375	38380.12	375
3838-3938.187	38380.12	187	3838-3938.387	38380.12	387
3838-3938-7838.20	38380.12	200	3838-3938.400	38380.12	400
3838-3938.212	38380.12	212			

38380.12 Full set, 4 parts
2 with pin / 2 with bore

Single-part order:

38380.1 Mounting bracket
moving end, 1 part left / right

38380.2 Mounting bracket
fixed end, 1 part left / right

Other strain relief elements
► chapter 10