

SHT-FF – Fast Forward

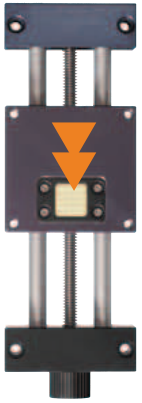

SHT linear tables with quick release mechanism offer a combination of accurate positioning and quick manual adjustment.

- Aluminum model
- For fast format adjustments
- Including self-locking brake
- Variable stroke length
- Only recommended for horizontal applications
- Max. stat. axial load 200 N (horizontal installation position)
- Max. dyn. axial load 50 N
- Available accessories ▶ page 1203



Order key
complete ▶ page 1172

SHT-12-AWM-FF

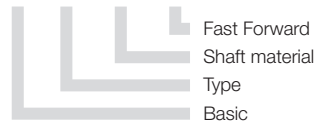

▶ page 1227

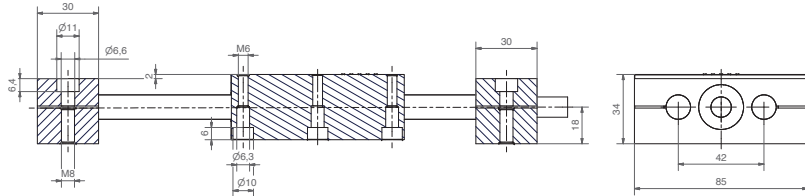
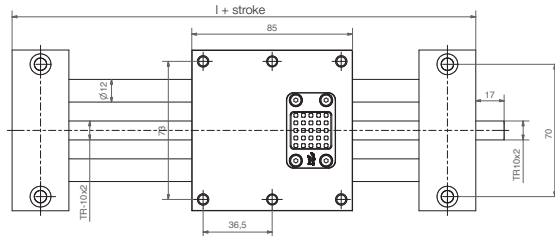

Technical Data

Part number	Max. length of stroke [mm]	Weight [kg]	Additional Weight per 100 mm
SHT-12-AWM-FF	750	1.1	0.1

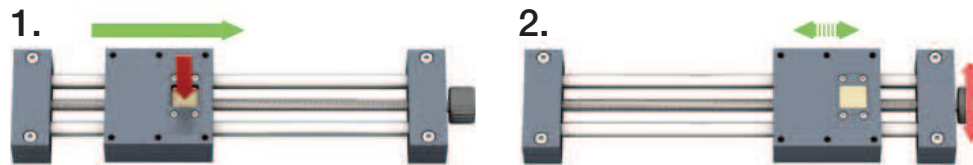

Press > disengage > move manually > click into place > fine-tune

delivery time 3-8 days

prices price list online
www.igus.eu/eu/SHT-FF

