

# PUNCH WITH EJECTOR PIN, STEPPED, SHORT POINT

268.

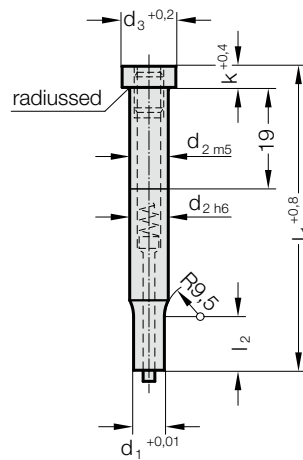
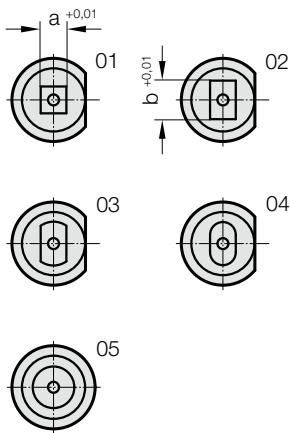

**Material:**

HSS  
 Order No 268.3.  
 Hardness:  
 Shaft 64 ± 2 HRC  
 Head 52 ± 5 HRC

Description of FIBRO materials for tool and die components see at the beginning of Chapter E.

**Execution:**

Punch head hot upset-forged. Shaft and shoulder precision plunge-ground.

Key flats parallel with longest size of shape, unless otherwise specified.

**Note:**

With kerf ≤ 0.04 mm, FIBRO rounds off sharp edges for shape 01 and shape 02 if the punch and piercing die bushing are ordered together. This reduces the fitting time and the risk of an edge break during operation.

268. Punch with ejector pin, stepped, short point

d <sub>1</sub>	d <sub>2</sub>	d <sub>3</sub>	k	l <sub>2</sub>	a <sub>min</sub>	l <sub>1</sub>	60	71	80	90	100
1.6 - 4.9	5	8	5	7	1.6		●	●	●	●	●
2.3 - 5.9	6	9	5	7	2.3		●	●	●	●	●
3.2 - 7.9	8	11	5	13	3.2		●	●	●	●	●
4.8 - 9.9	10	13	5	13	4.8		●	●	●	●	●
4.8 - 12.9	13	16	5	13	4.8		●	●	●	●	●
5.5 - 15.9	16	19	6.4	13	5.5		●	●	●	●	●
5.5 - 19.9	20	23	6.4	13	5.5		●	●	●	●	●
6.5 - 24.9	25	28	6.4	13	6.5		●	●	●	●	●

**Ordering Code (example):**

Punch with ejector pin, stepped, short point	=	268.3.
Shaft diameter d <sub>2</sub>	13 mm =	1300.
Length l <sub>1</sub>	60 mm =	060.
Cutting form FORM	square =	01.
Cutting form width a	4.8 mm =	0480.
Cutting form length b	4.8 mm =	0480
Order No	=	268.3. 1300.060. 01.0480. 0480