

PUNCH WITH EJECTOR PIN

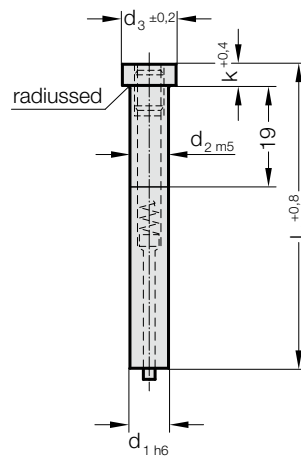

267.



267. Punch with ejector pin

$d_{1\ h6}$	d_3	k	l_1	60	71	80	90	100
5	8	5		●	●	●	●	●
6	9	5		●	●	●	●	●
8	11	5		●	●	●	●	●
10	13	5		●	●	●	●	●
13	16	5		●	●	●	●	●
16	19	6.4		●	●	●	●	●
20	23	6.4		●	●	●	●	●
25	28	6.4		●	●	●	●	●

Material:

HSS

Order No 267.3.

Hardness:

Shaft 64 ± 2 HRC

Head 52 ± 5 HRC

Description of FIBRO materials for tool and die components see at the beginning of Chapter E.

Execution:

Punch head hot upset-forged. Shaft and shoulder precision plunge-ground.

Ordering Code (example):

Punch with ejector pin	=	267.
Material MAT	HSS	= 3.
Shaft diameter d_1	13 mm	= 1300.
Length l_1	60 mm	= 060
Order No	=	267. 3.1300.060