

GUIDE BUSH FOR PUNCH, DIN 9845 SHAPE C

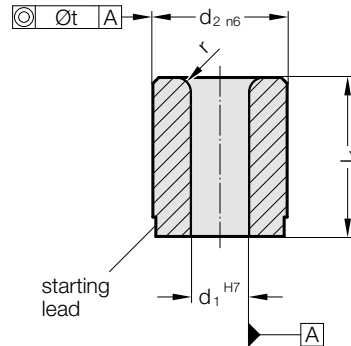

262.



262. Guide bush for punch, DIN 9845 Shape C

Gradation					
d_1	d_1	d_2	t	l_1	r
0,5 - 1	0.1	5	0.01	9	1
1,1 - 2	0.1	6	0.01	12	1
2,1 - 3	0.1	7	0.01	12	1
3,1 - 4	0.1	8	0.01	12	1
4,1 - 5	0.1	10	0.01	16	1
5,1 - 6	0.1	12	0.02	16	1.5
6,1 - 8	0.1	15	0.02	20	1.5
8,1 - 10	0.1	18	0.02	20	2
10,1 - 12	0.1	22	0.02	28	2
12,1 - 15	0.1	26	0.02	28	2
15,1 - 18	0.5	30	0.02	36	2

Material:

Case hardened steel
Hardness 740 ± 40 HV 10

Execution:

Diameters d_1 , d_2 and starting lead ground.

Ordering Code (example):

Guide bush for punch, DIN 9845 Shape C	=	262.1.
Diameter of conduit d_1	5.1 mm =	0510.
Length l_1	16 mm =	016
Order No	=	262.1. 0510. 016