

LOCKING PIN SHAPE A, ACCORDING TO BMW

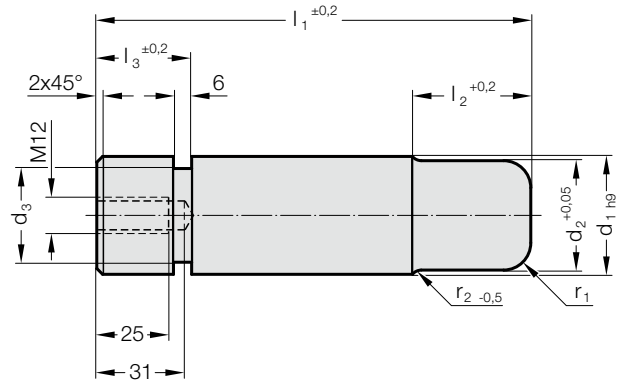

2446.12.15.



Mounting example

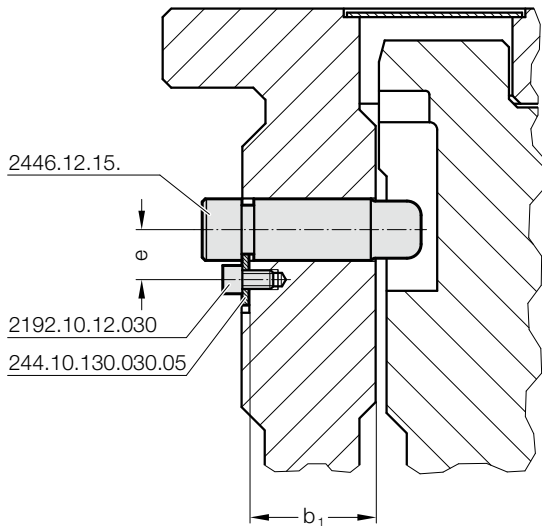

Description:

Studs are inserted as securing elements for pads and spring bases and used as holding elements in combination with damping plugs.

Material:

$d_1 < 40 \text{ mm} = 42\text{CrMoS4+QT (1.7227)}$, heat-treated $1000+200 \text{ N/mm}^2$
 $d_1 \geq 40 \text{ mm} = 42\text{CrMoS4+QT (1.7227)}$, heat-treated $900+200 \text{ N/mm}^2$

Note:

Supplied without sheave and screw

2446.12.15. Locking pin Shape A, according to BMW

Order No	d_1	d_2	d_3	l_1	l_2	l_3	r_1	r_2	e	Permissible static load [kN]	Permissible dynamic load [kN]
2446.12.15.032.111	32	29	24	111	31	22	8	4	30	20	3
2446.12.15.032.128	32	29	24	128	31	22	8	4	30	20	3
2446.12.15.040.145	40	37	32	145	38	32	10	5	34	32	5
2446.12.15.040.165	40	37	32	165	38	32	10	5	34	32	5
2446.12.15.050.171	50	47	42	171	44	32	12	6	39	50	7.5
2446.12.15.050.196	50	47	42	196	44	32	12	6	39	50	7.5
2446.12.15.063.206	63	60	55	206	54	32	15	6	45.5	90	12.5
2446.12.15.063.241	63	60	55	241	54	32	15	6	45.5	90	12.5