

BALL-LOCK PUNCH, STEPPED, ROUND, HEAVY DUTY

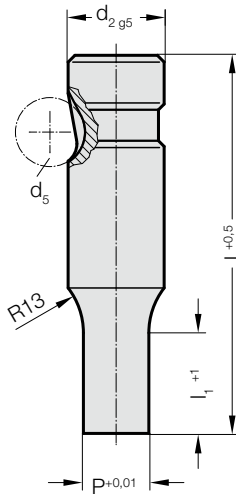

2213.



2213. Ball-Lock punch, stepped, round, heavy duty

d ₂ / Order No	d ₅	P	l ₁ / Order No	l (Order Code character)	63 (C)	71 (D)	80 (E)	90 (F)	100 (G)	110 (H)	125 (J)
10 / (2)	10	1,6 - 9,9	13(1) 19(2)		●	●	●	●	●	●	●
13 / (3)	12	5 - 12,9	13(1) 19(2)		●	●	●	●	●	●	●
16 / (4)	12	8 - 15,9	13(1) 19(2) 25(3)		●	●	●	●	●	●	●
20 / (5)	12	12 - 19,9	13(1) 19(2) 25(3)		●	●	●	●	●	●	●
25 / (6)	12	16 - 24,9	13(1) 19(2) 25(3)			●	●	●	●	●	●
32 / (7)	12	24 - 31,9	13(1) 19(2) 25(3)			●	●	●	●	●	●
40 / (9)	12	30 - 39,9	19(2) 25(3) 30(4)				●	●	●	●	●

l₁=10 where P < 2.20

Material:

HSS
Hardness 62 ± 2 HRC

Execution:

Shaft and punch diameter fine ground.
Special dimensions on request.

Ordering Code (example):

2213.7G2.2450

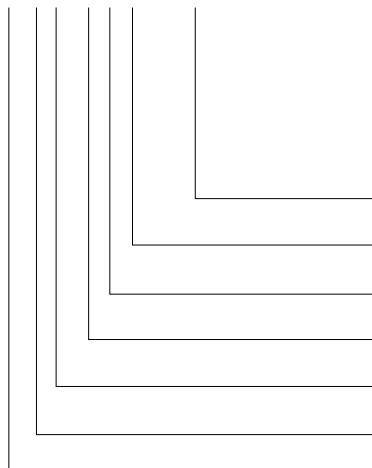

Shape: round

P = Ø 24,5 mm

Punch cutting length: l₁

19 mm

Length: l

100 mm

Diameter: d₂

32 mm

Type:

heavy

Execution:

round

Punch:

without ejector pin

= 2450

Order No

= (2)

Order Code character

= (G)

Order No

= (7)

Order No

= (3)

Order No

= (1)

= 22