

# GUIDE BUSH WITH COLLAR, FOR BALL BEARING, ~AFNOR

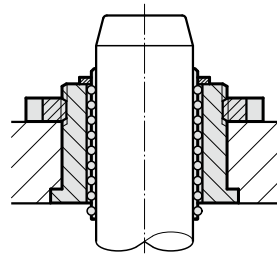

Mounting example



210.45.

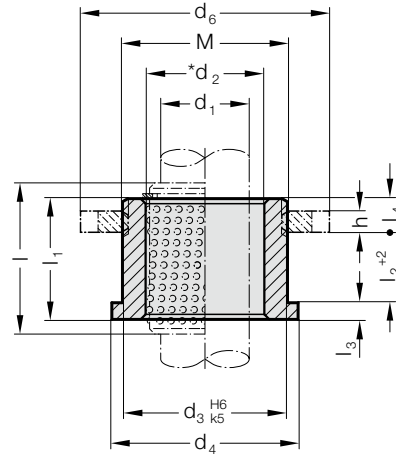

**Material:**

Tool steel, hardened 62 ± 2 HRC

**Execution:**

Bearing surfaces honed,  
outside diameter precision ground.

**Note:**

The guide bush is fixed with slotted nut 207.48.

☞ Notes on ball bearing type guides at the beginning of chapter D.

\*☞ Preloading see pairing classification at the beginning of chapter D

☞ Matching guide combinations, see selection matrix at the beginning of chapter D.

☞ Ball guide capacity calculations at the end of chapter D.

☞ Assembly guide lines / Dimensional requirements and tolerances at the end of chapter D.

Tolerance range:

yellow = .10

green = .20

red = .30

**210.45. Guide bush with collar, for ball bearing, ~AFNOR**

d <sub>1</sub>	16	16	20	20	20	25	25	25	32	32	32	40	40	40	50	50
d <sub>2</sub>	22	22	26	26	26	31	31	31	40	40	40	48	48	48	58	58
d <sub>3</sub>	28	28	32	32	32	40	40	40	50	50	50	63	63	63	80	80
d <sub>4</sub>	32	32	36	36	36	45	45	45	56	56	56	70	70	70	90	90
d <sub>6</sub>	40	40	44	44	44	55	55	55	65	65	65	81	81	81	100	100
M	M27x1	M27x1	M30x1	M30x1	M30x1	M39x1	M39x1	M39x1	M48x1	M48x1	M48x1	M60x1	M60x1	M60x1	M76x1	M76x1
h	3	3	4	4	4	4	4	4	5	5	5	6	6	6	8	8
l <sub>1</sub>	16	20	17	21	25	22	26	31	26	31	38	32	39	47	41	49
l <sub>2</sub>	8	12	8	12	16	12	16	21	15	20	27	20	27	35	26	34
l <sub>3</sub>	3	3	3	3	3	3	3	3	4	4	4	4	4	4	5	5
l <sub>4</sub>	5	5	6	6	6	7	7	7	7	7	7	8	8	8	10	10
l*	24	28	24	28	31	31	40	40	40	40	50	50	50	56	50	63

\*l = Nominal ordering length of ball cage - preferred length

**Ordering Code (example):**

Guide bush with collar, for ball bearing, ~AFNOR	=	210.45.
Diameter of conduit d <sub>1</sub>	32 mm =	032.
total length l <sub>1</sub>	26 mm =	026.
Classification TOL	yellow =	10
Order No	=	210.45.032.026.10