

GUIDE BUSH FOR BALL BEARING, FOR HIGHEST STROKING SPEED

GUIDE BUSH FOR BALL BEARING, ISO 9448-3

2062.44.012.

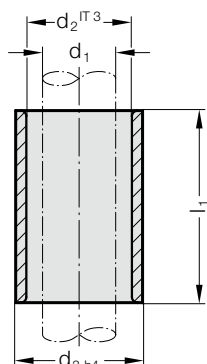

2062.44.012. Guide bush for ball bearing, for highest stroking speed

Order No	d ₁	d ₂	d ₃	l ₁	For ball Ø
2062.44.012.016.032	12	16	20	32	2
2062.44.012.017.032	12	17	20	32	2.5

Material:
Tool steel, hardened 62 ± 2 HRC

Execution:
Bearing surfaces honed,
outside diameter precision ground.

Note:
For use with ball cage 206.41. and guide pillar 202.61.

2061.44.015.

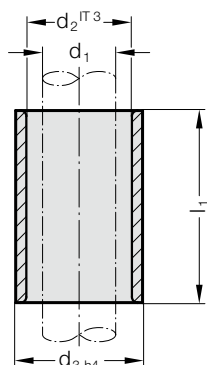

2061.44. Guide bush for ball bearing, ISO 9448-3

Order No	d ₁	d ₂	d ₃	l ₁
2061.44.015.023.10	15	21	28	23
2061.44.015.023.20	15	21	28	23
2061.44.015.030.10	15	21	28	30
2061.44.015.030.20	15	21	28	30
2061.44.015.037.10	15	21	28	37
2061.44.015.037.20	15	21	28	37
2061.44.015.047.10	15	21	28	47
2061.44.015.047.20	15	21	28	47
2061.44.015.060.10	15	21	28	60
2061.44.015.060.20	15	21	28	60

Material:
Tool steel, hardened 62 ± 2 HRC

Execution:
Bearing surfaces honed,
outside diameter precision ground.

Note:
For use with ball cage 206.41. and guide pillar 202.61.
Tolerance range:
yellow = .10
green = .20