

# GUIDE PILLAR ECO-LINE, ~DIN 9825/~ISO 9182-2

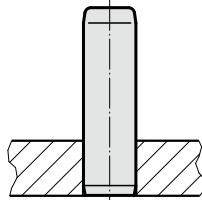

Mounting example



202.29.

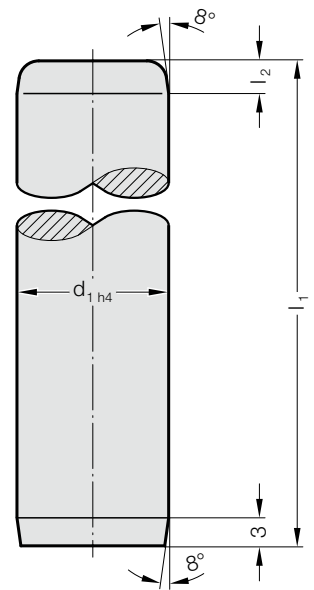

**Material:**

Steel, surface hardened  
 Surface hardness: 60 + 3 HRC, Hardness penetration  $\geq 1,8$  mm

**Execution:**

ground  
 Method of manufacturing entails that centre holes are not concentric with O.D.

**Note:**

Guide pillars only recommended for use with sliding guides!  
 ☞ Matching guide combinations, see selection matrix at the beginning of chapter D.  
 ☞ Assembly guide lines / Dimensional requirements and tolerances at the end of chapter D.

**202.29. Guide pillar ECO-LINE, ~DIN 9825/~ISO 9182-2**

$d_1$	15 16	19 20	24 25	30 32	38 40	48 50	60 63	80
$l_2$	4	4	6	6	6	8	8	8
$l_1$								
90	●							
100	●							
112	●	●	●					
125	●	●	●	●				
140	●	●	●	●				
160	●	●	●	●	●			
180	●	●	●	●	●	●		
200	●	●	●	●	●	●		
224	●	●	●	●	●	●		
250	●	●	●	●	●	●	●	
280	●	●	●	●	●	●	●	●
315	●	●	●	●	●	●	●	●
355	●	●	●	●	●	●	●	●
400		●	●	●	●	●	●	●
450			●	●	●	●	●	●
500			●	●	●	●	●	●
550				●	●	●	●	●
600					●	●	●	●
700					●	●	●	●
800					●	●	●	●

**Ordering Code (example):**

Guide pillar ECO-LINE, ~DIN 9825/~ISO 9182-2	=	202.29.
Diameter of conduit $d_1$	32 mm =	032.
Length $l_1$	125 mm =	125
Order No	=	202.29. 032. 125