

**Human Machine Interface  
Operating Housing | Mild Steel  
Control enclosure | OICE**

**IP 55 | IK 10**



**Material:**

Body and door made from 1.2 mm mild steel, front cover and handles made in aluminium.

**Body:**

Folded and seam welded, with maximum opening. The front fitted with an aluminium front panel. Handling grips mounted to front, left and right edges.

**Rear door:**

Surface mounted with 130° opening. Concealed removable hinges with captive pin. Hinges can be mounted to allow left or right hand opening. Door profiles MMDP are available as an accessory.

**Lock:**

Customised lock with double grip for easy opening of the door. Double-bit 3 mm insert and 90° movement. Other inserts and locks are available as an accessory.

**Protection:**

IP 55 | IK 10.

**Finish:**

RAL 7035 structured powder coating.

**Approvals:**

CE, GOST.

**Delivery:**

Enclosure with aluminium front panel, rear door, plastic double-bit 3 mm key, and mounting accessories.



# Dimensional table | OICE

IP 55 | IK 10

Enclosure dimensions			Item no.
H	W	D	
300	300	155	OICE303015
300	400	210	OICE304021
400	400	210	OICE404021
400	600	210	OICE406021
500	500	210	OICE505021
500	600	210	OICE506021



Front view

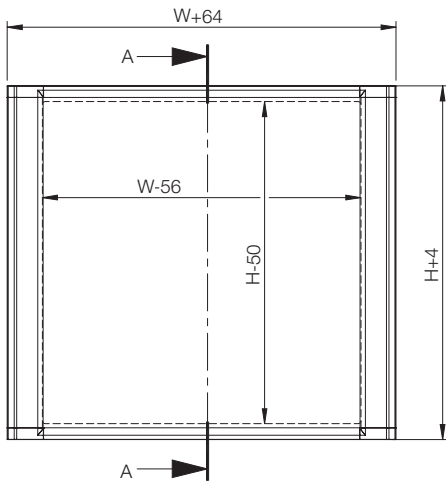

Sectional side view

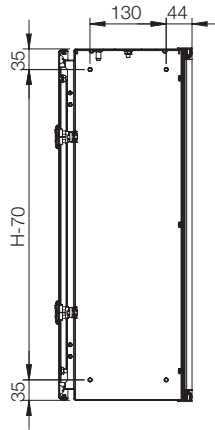

Rear view

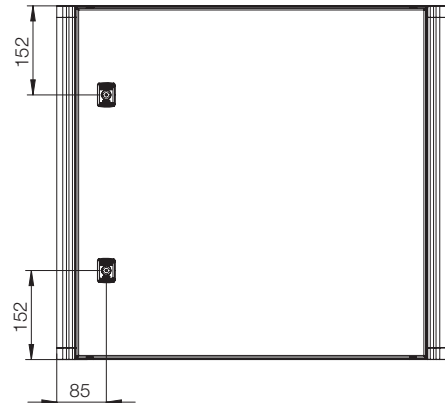

SECTION A-A

Top view

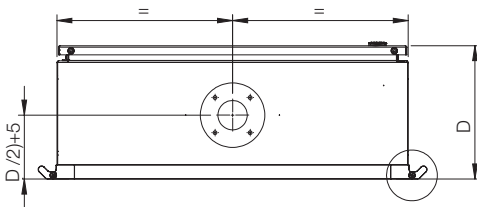

Detail view

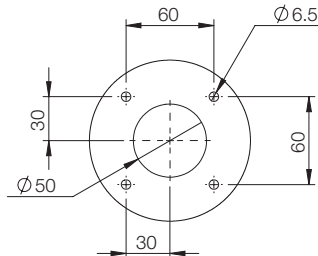

Scale 1 : 4

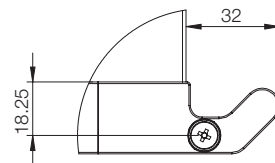

Scale 1 : 2

Aluminium panel

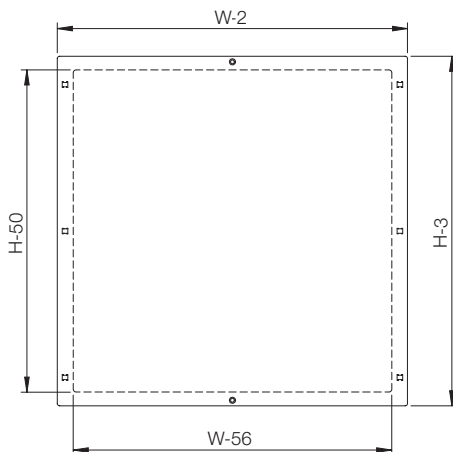

Inside door view

