

# CS-KC 7500 V1

Power Compact Stroke

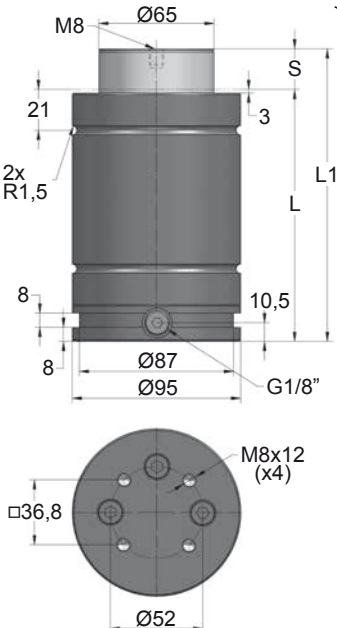

ORDER	S (mm)	L1 ±0,25 (mm)	L (mm)	Kg.
CS-KC 7500 010 V1	10	110	100	4.16
CS-KC 7500 016 V1	16	136	120	4.57
CS-KC 7500 025 V1	25	165	140	5.01
CS-KC 7500 032 V1	32	202	170	5.59
CS-KC 7500 040 V1	40	230	190	6.03
CS-KC 7500 050 V1	50	275	225	6.73
CS-KC 7500 065 V1	65	299	234	7.08

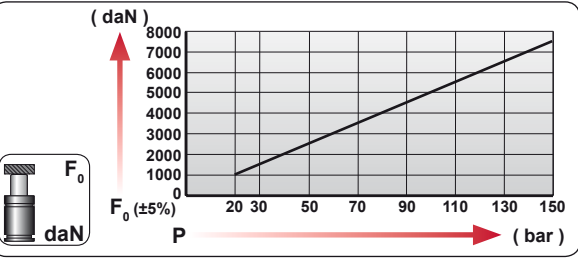

CODE				
	bar	psi	daN	daN
-----	---	---	---	---
CS-KC 7500 050 V1	0	0	---	---

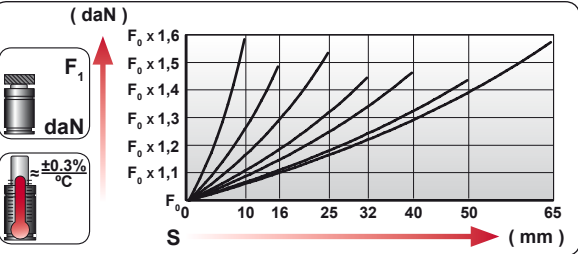

ENG ORDER  
 DEU BESTELLUNG  
 FRA COMMANDE  
 ITA ORDINE  
 ESP PEDIDO  
 POR PEDIDO

**F<sub>0</sub>** daN  
**S** mm

**CS-KC 7500 50**  
**CS-KC 7500 050 V1**

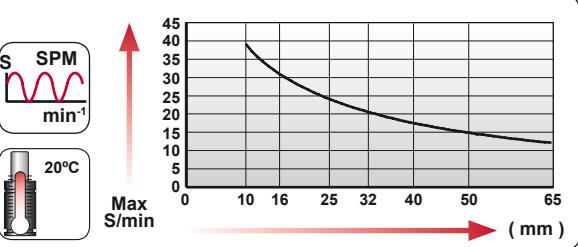

	<b>S<sub>max</sub> &lt; 90%</b>	<b>V<sub>max</sub> 0,5 m/s</b>	<b>P<sub>min</sub> (20°C)</b>	<b>P<sub>max</sub> (20°C)</b>	<b>T<sub>min</sub></b>	<b>T<sub>max</sub></b>	
--	---------------------------------	--------------------------------	-------------------------------	-------------------------------	------------------------	------------------------	--

N <sub>2</sub>	S <sub>max</sub> < 90%	V <sub>max</sub> 0,5 m/s	bar psi	bar psi	°C °F	°C °F	600 CP-
			20 290	150 2175	0 32	80 176	

