

NPT straight fitting, male, stainless steel (AISI-303).

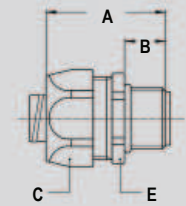

Thread	Sealtite Size (inch)	Min. Internal Bore (mm)	Dimensions in mm					Standard Package	Article Number	Weight (Kg/100)
			A	B	C	D	E			
1/2" NPT	5/16"	8,3	37	13	27	-	24	10	814.011.9*	6,0
1/2" NPT	3/8"	10,2	37	13	27	-	24	10	814.012.9	6,0
1/2" NPT	1/2"	13,9	37	13	30	-	27	10	814.016.9	6,7
3/4" NPT	3/4"	18,5	40	15	36	-	36	5	814.020.9	9,6
1" NPT	1"	23,8	46	15	46	-	46	5	814.026.9	27,0

* Fittings for 5/16" conduit without UL/CSA approval., a special connection set will be delivered separately.

NPT 45° fitting, male, stainless steel (AISI-303).

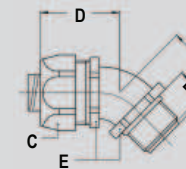

Thread	Sealtite Size (inch)	Min. Internal Bore (mm)	Dimensions in mm					Standard Package	Article Number	Weight (Kg/100)
			A	B	C	D	E			
1/2" NPT	5/16"	8,3	25	13	27	33	22	10	814.411.9*	8,5
1/2" NPT	3/8"	10,2	25	13	27	33	22	10	814.412.9	8,5
1/2" NPT	1/2"	13,9	25	13	30	33	27	10	814.416.9	11,6
3/4" NPT	3/4"	18,5	30	15	36	36	33	5	814.420.9	17,0

* Fittings for 5/16" conduit without UL/CSA approval., a special connection set will be delivered separately.

NPT 90° fitting, male, stainless steel (AISI-303).

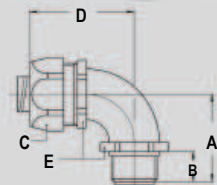

Thread	Sealtite Size (inch)	Min. Internal Bore (mm)	Dimensions in mm					Standard Package	Article Number	Weight (Kg/100)
			A	B	C	D	E			
1/2" NPT	5/16"	8,3	36	13	27	43	22	10	814.911.9*	14,4
1/2" NPT	3/8"	10,2	36	13	27	43	22	10	814.912.9	14,4
1/2" NPT	1/2"	13,9	36	13	30	43	27	10	814.916.9	15,8
3/4" NPT	3/4"	18,5	43	15	36	48	33	5	814.920.9	23,8
1" NPT	1"	23,8	48	15	46	59	42	5	814.926.9	34,2

* Fittings for 5/16" conduit without UL/CSA approval., a special connection set will be delivered separately.

Grounding ferrule, nickel plated brass.



Thread	Sealtite Size (inch)	Min. Internal Bore (mm)	Dimensions in mm					Standard Package	Article Number	Weight (Kg/100)
			A	B	C	D	E			
-	5/16"	8,3	-	-	-	-	-	10	815.010.0	0,8
-	3/8"	10,2	-	-	-	-	-	10	815.011.4	0,6
-	1/2"	13,9	-	-	-	-	-	10	815.016.4	0,8
-	3/4"	18,5	-	-	-	-	-	5	815.021.4	1,4
-	1"	23,8	-	-	-	-	-	5	815.029.4	2,8
-	1.1/4"	31,8	-	-	-	-	-	2	815.036.0	6,0
-	1.1/2"	36,8	-	-	-	-	-	2	815.042.0	6,8
-	2"	47,8	-	-	-	-	-	2	815.048.0	8,8

ANACONDA
SEALTITE®
SPECIAL

LIQUID-TIGHT
FITTINGS FOR
SEALTITE
IP 67