



Anaconda Adapter in full metal for various makes proximity switches.

These Anaconda proximity switch adapters are used in combination with the various of adapters (fixed wiring connection) in hazardous environments. By using an inner thread for the proximity switch and an outer thread with locknut, this adapter is easy to mount and gives a perfect protection. Due to the construction they are easy to connect in combination with Sealtite conduit. Other combinations are also possible.



Material & Construction:

Construction: Nickel plated brass, consisting of 5 parts (counter nut, clamping ring, ferrule, body and locknut).

Material: Counter nut, ferrule, body and locknut are nickel plated brass. Clamping ring is made of Polyamide PA6.

Temperature: -45 °C till +105 °C continuous.

Protection class: IP 65.

Colour: Metal.

ANACONDA
SPECIAL
FITTINGS

PROXIMITY
SWITCH
ADAPTER

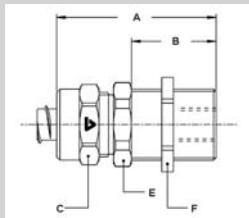

Proximity switch adapter for *Anaconda Sealtite*, IP 65 (for conduit details see chapters 3 and 4).



| Female Thread size | Sealtite Size | Male Thread | Min. Internal Bore (mm) | Dimensions in mm | | | | | Standard Package | Article Number | Weight (Kg/100) |
|-----------------------|------------------|----------------|----------------------------|------------------|----|----|----|----|---------------------|-------------------|--------------------|
| | | | | A | B | C | E | F | | | |
| M8 x 1 | 1/4" | M12 x 1,5 | 5,2 | 34 | 12 | 19 | 17 | 15 | 10 | 884.008.0 | 3,0 |
| M12 x 1 | 1/4" | M16 x 1,5 | 5,2 | 38 | 16 | 19 | 17 | 20 | 10 | 884.012.0 | 3,5 |
| M14 x 1 | 1/4" | M18 x 1,5 | 5,2 | 42 | 20 | 19 | 20 | 22 | 10 | 884.014.0 | 4,0 |
| M18 x 1 | 5/16" | M22 x 1,5 | 8,3 | 49 | 26 | 22 | 24 | 26 | 10 | 884.018.0 | 6,0 |
| M30 x 1,5 | 5/16" | M35 x 1,5 | 8,3 | 53 | 30 | 22 | 36 | 46 | 5 | 884.030.0 | 13,0 |