

# ANACONDA SEALTITE CONDUIT TYPE NMUA GREY

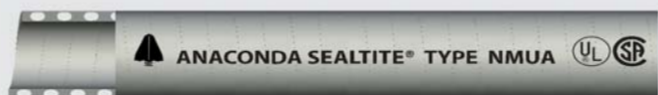

**All-plastic, medium mechanical strength, flexible, UL & CSA approved (type B)**

The NMUA is the universal applicable all plastic Sealtite conduit. The lead-free PVC cover is perfect for applications where no high demands or extreme circumstances will influence the conduit. For this reason type NMUA is used in the machine and apparatus industry, train-warning-systems, and the food industry. Type NMUA is particularly used where an UL/CSA approval is demanded.



Spiral reinforced PVC

### Material & Construction:

**Construction:** Thick smooth thermoplastic (PVC compound) core reinforced with PVC spiral.

**Cover specifications:** PVC, smoothbore in- and outside, with PVC spiral reinforced, lead-free according to RoHS, sunlight and UV resistant, suitable for outside and burial installation.

**Special approvals:** UL- 1660 type B (file # E 211327) and CSA C22.2 (file # 20817)

**Temperature range:** -20 °C till +80 °C, intermittent up to +100 °C. For CSA -18 °C till +75 °C.

**Colour:** Grey.



### Classification according NEN-EN-IEC 61386:

**Compression resistance:** Class 2, Light (320 N).

**Impact resistance:** Class 3, Medium (2 J).

**Tensile strength:** Class 4, Heavy (1000 N).

**Protection class:** IP 66 / 67 (dust-proof, water-tight).

Sealtite	Diametre		Bending radius		Standard carton		Small carton		Reels		Weight (Kg/m)
	Size (Inch)	Inside (mm)	Outside (mm)	Static (mm)	Dynamic (mm)	Metre	Article No.	Metre	Article No.	Metre	
						Grey		Grey		Grey	
3/8"	12,6	17,8	70	100	30	300.012.0	-	-	-	-	0,13
1/2"	16,0	21,1	100	135	30	300.016.0	-	-	-	-	0,20
3/4"	21,1	26,4	130	175	30	300.020.0	-	-	-	-	0,30
1"	26,8	33,1	180	220	30	300.026.0	-	-	-	-	0,38
1.1/4"	35,4	41,8	225	270	15	300.035.0	-	-	-	-	0,55
1.1/2"	40,3	47,8	255	320	15	300.040.0	-	-	-	-	0,70
2"	51,6	59,9	310	400	15	300.050.0	-	-	-	-	1,00

The fittings for Sealtite NMUA are outlined on pages 8-08 till 8-10. Sealtite fittings illustrated in chapter 5 can also be used.



Sealtite	1/4"	5/16"	3/8"	1/2"	3/4"	1"	1.1/4"	1.1/2"	2"	2.1/2"	3"	4"
ISO	M10 / M12	M16 / M20	M16 / M20	M20	M25	M32	M40	M50 / M63	M50 / M63	M75	M90	-
Pg	7	9-11	11 / 13,5	16	21	29	36	42	48	-	-	-
NPT	-	-	1/2"	1/2"	3/4"	1"	1.1/4"	1.1/2"	2"	2.1/2"	3"	4"

# ANAMET FITTINGS FOR ALL PLASTIC, IP67, POLYAMIDE



## Anamet, halogenfree, polyamide fittings for Anaconda Sealtite NMUA / NMSF / NMFG.

These polyamide PA6 Anamet fittings are specially made for the combination with Anaconda Sealtite NMUA / NMSF and NMFG. This fitting offers liquid-tightness in combination with the UL & CSA approvals which makes them also suitable for export projects outside Europe.

### Material & Construction:

**Construction:** Plastic fitting, consisting of 2 parts (counter nut and body).

**Material:** Polyamide PA-6, V-2, halogenfree.

**Special approvals:** UL- 1660, type A (file # E234207) and CSA C22.2 (file #E234207).

**Temperature:** -40 °C till +120 °C continuous.

**Protection class:** IP 67 (dust-proof, water-tight).

**Colour:** Grey.



### ISO straight fitting, male, PA 6

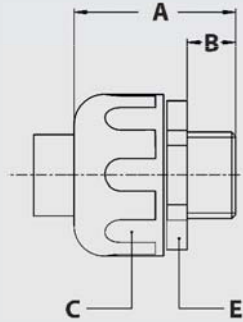

Thread ISO	Sealtite Size (inch)	Min. Internal Bore (mm)	Dimensions in mm					Standard Package	Article Number	Weight (Kg/100)
			A	B	C	D	E			
M16 x 1,5	3/8"	10,9	47	14	35	-	33	25	263.016.0	2,0
M20 x 1,5	1/2"	14,4	47	14	35	-	33	25	263.020.0	2,3
M25 x 1,5	3/4"	18,0	49	16	43	-	39	10	263.025.0	3,4
M32 x 1,5	1"	23,9	53	16	49	-	44	5	263.032.0	5,8
M40 x 1,5	1.1/4"	31,8	45	16	54	-	-	5	300.140.0*	-

\* Size M40 is without UL/CSA approval and the shape is different from the picture.



### ISO 90° fitting, male, PA 6

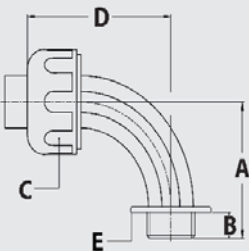

Thread ISO	Sealtite Size (inch)	Min. Internal Bore (mm)	Dimensions in mm					Standard Package	Article Number	Weight (Kg/100)
			A	B	C	D	E			
M16 x 1,5	3/8"	10,9	30	13	35	60	31	10	263.116.0	2,4
M20 x 1,5	1/2"	14,4	30	13	35	60	31	10	263.120.0	2,9
M25 x 1,5	3/4"	18,0	40	14	43	68	37	10	263.125.0	4,1
M32 x 1,5	1"	23,9	50	16	49	82	45	5	263.132.0	6,7

# ANAMET FITTINGS FOR ALL PLASTIC, IP67, POLYAMIDE



NPT straight fitting, male, PA 6  
(including seal and lock nut)

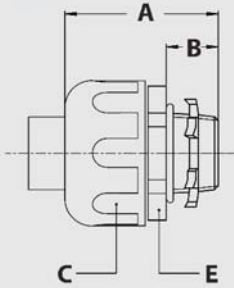

Thread	Sealtite Size (inch)	Min. Internal Bore (mm)	Dimensions in mm					Standard Package	Article Number	Weight (Kg/100)
			A	B	C	D	E			
1/2"	3/8"	10,9	47	14	35	-	33	25	263.312.0	2,3
1/2"	1/2"	14,4	47	14	35	-	33	25	263.316.0	2,6
3/4"	3/4"	18,0	49	16	43	-	39	10	263.320.0	3,8
1"	1"	23,9	53	16	49	-	44	5	263.326.0	6,3
1.1/4"	1.1/4"	30,6	60	18	59	-	55	5	263.335.0	9,5
1.1/2"	1.1/2"	35,4	64	19	66	-	61	1	263.340.0	10,3
2"	2"	47,8	72	21	83	-	79	1	263.350.0	19,5



NPT 90° fitting, male, PA 6  
(including seal and lock nut)

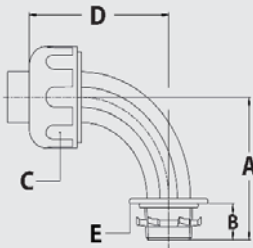

Thread	Sealtite Size (inch)	Min. Internal Bore (mm)	Dimensions in mm					Standard Package	Article Number	Weight (Kg/100)
			A	B	C	D	E			
1/2"	3/8"	10,9	30	13	35	60	31	10	263.412.0	2,7
1/2"	1/2"	14,4	30	13	35	60	31	10	263.416.0	3,2
3/4"	3/4"	18,0	40	14	43	68	37	10	263.420.0	4,5
1"	1"	23,9	50	16	49	82	45	5	263.426.0	7,2
1.1/4"	1.1/4"	30,6	68	18	59	84	54	5	263.435.0	14,4
1.1/2"	1.1/2"	35,4	70	19	66	88	59	1	263.440.0	16,8
2"	2"	47,8	73	21	83	90	74	1	263.450.0	27,2

General Index
Anaconda Multiflex
Anaconda Multitite
Anaconda Sealtite
Anaconda Sealtite Spec.
Anaconda Fittings
Anaconda Accessories
Anaconda IECEx - Atex
Anaconda All Plastic

# COMPACT FITTINGS, IP 66 / IP 67, NICKEL PLATED BRASS



## Anaconda compact nickel plated brass fittings for NMUA / NMSF.

Anaconda compact nickel plated brass fittings can be used Anaconda Sealtite type NMUA and NMSF. The Anaconda compact range contains less material, are shorter in length and lighter in weight than the Anaconda standard range of fittings. They are ideal in standard applications and installations where space is limited. By using a special ferrule the fittings have a perfect fit and are easy to install.

**Construction:** Nickel plated brass fitting, consisting of 4 parts (counter nut, clamping ring, ferrule and body).

**Material:** Counter nut, body and ferrule are nickel plated brass. Clamping ring is made from PA6. The O-rings are from NBR rubber (black for ISO and blue for Pg).

**Temperature:** -45 °C till +105 °C continuous

**Protection class:** IP 66 / 67, Nema 4X.

Cable hose fittings are IP 68 on the switchbox.

**Colour:** Metal

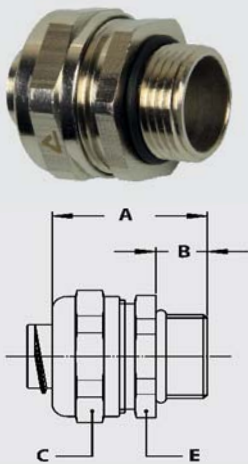

ISO straight fitting, compact, male, nickel plated brass.



Thread	Sealtite	Min. Internal	Dimensions in mm					Standard	Article	Weight
ISO	Size (NW)	Bore (mm)	A	B	C	D	E	Package	Number	(Kg/100)
M16 x 1,5	3/8"	10,6	31	10	26	-	24	10	712.016.0-NM	3,9
M20 x 1,5	3/8"	10,6	31	10	26	-	24	10	712.017.0-NM	4,0
M20 x 1,5	1/2"	14,0	32	10	29	-	27	10	712.020.0-NM	4,4
M25 x 1,5	3/4"	19,1	33	10	35	-	33	5	712.025.0-NM	6,6
M32 x 1,5	1"	24,3	36	12	45	-	42	5	712.032.0-NM	11,7
M40 x 1,5	1.1/4"	32,7	40	13	53	-	50	2	712.040.0-NM	16,0
M50 x 1,5	1.1/2"	37,4	46	14	62	-	58	2	712.050.0-NM	25,3
M63 x 1,5	2"	47,9	52	16	76	-	72	2	712.063.0-NM	38,6

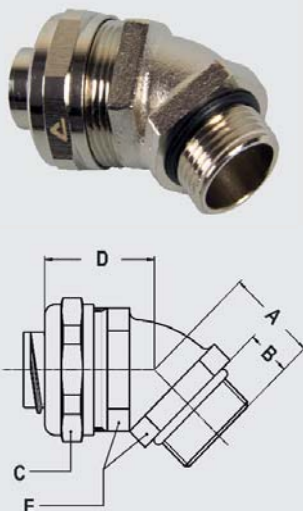

ISO 45° fitting, compact, male, nickel plated brass



Thread	Sealtite	Min. Internal	Dimensions in mm					Standard	Article	Weight
ISO	Size (NW)	Bore (mm)	A	B	C	D	E	Package	Number	(Kg/100)
M16 x 1,5	3/8"	10,6	19	10	26	27	22	10	712.416.0-NM	6,3
M20 x 1,5	3/8"	10,6	20	10	26	28	24	10	712.417.0-NM	7,2
M20 x 1,5	1/2"	14,0	21	10	29	30	27	10	712.420.0-NM	8,3
M25 x 1,5	3/4"	19,1	23	10	35	33	33	5	712.425.0-NM	12,8
M32 x 1,5	1"	24,3	28	12	45	38	42	5	712.432.0-NM	22,5
M40 x 1,5	1.1/4"	32,7	33	13	53	39	52	2	712.440.0-NM	34,5
M50 x 1,5	1.1/2"	37,4	35	14	62	46	60	2	712.450.0-NM	50,0
M63 x 1,5	2"	47,9	40	16	76	53	72	2	712.463.0-NM	80,5

# COMPACT FITTINGS, IP 66 / IP 67, NICKEL PLATED BRASS

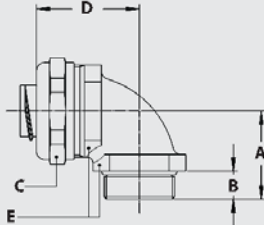

ISO 90° fitting, compact, male, nickel plated brass.



Thread	Sealtite	Min. Internal	Dimensions in mm					Standard	Article	Weight
ISO	Size (NW)	Bore (mm)	A	B	C	D	E	Package	Number	(Kg/100)
M16 x 1,5	3/8"	10,6	26	10	26	31	22	10	712.916.0-NM	6,6
M20 x 1,5	3/8"	10,6	26	10	26	32	24	10	712.917.0-NM	7,9
M20 x 1,5	1/2"	14,0	28	10	29	34	27	10	712.920.0-NM	9,2
M25 x 1,5	3/4"	19,1	32	10	35	40	33	5	712.925.0-NM	16,2
M32 x 1,5	1"	24,3	40	12	45	49	42	5	712.932.0-NM	27,8
M40 x 1,5	1.1/4"	32,7	46	13	53	53	52	2	712.940.0-NM	40,1
M50 x 1,5	1.1/2"	37,4	52	14	62	57	60	2	712.950.0-NM	57,5
M63 x 1,5	2"	47,9	62	16	76	68	72	2	712.963.0-NM	90,6



Grounding ferrule for non-metallic conduit, nickel plated brass



Thread	Sealtite	Min. Internal	Dimensions in mm					Standard	Article	Weight
ISO	Size (NW)	Bore (mm)	A	B	C	D	E	Package	Number	(Kg/100)
-	3/8"	10,6	-	-	-	-	-	10	815.011.6	0,8
-	1/2"	14,0	-	-	-	-	-	10	815.016.6	1,1
-	3/4"	19,1	-	-	-	-	-	5	815.021.6	1,7
-	1"	24,3	-	-	-	-	-	5	815.029.6	2,5



Grounding ferrule for non-metallic conduit, nickel plated brass



Thread	Sealtite	Min. Internal	Dimensions in mm					Standard	Article	Weight
ISO	Size (NW)	Bore (mm)	A	B	C	D	E	Package	Number	(Kg/100)
-	1.1/4"	32,7	-	-	-	-	-	2	815.036.6	4,6
-	1.1/2"	37,4	-	-	-	-	-	2	815.042.6	6,8
-	2"	47,9	-	-	-	-	-	2	815.048.6	10,7

General Index  
Anaconda Multiflex  
Anaconda Multitite  
Anaconda Sealrite  
Anaconda Sealrite Spec.  
Anaconda Fittings  
Anaconda Accessories  
Anaconda IECEx - Atex  
Anaconda All Plastic