

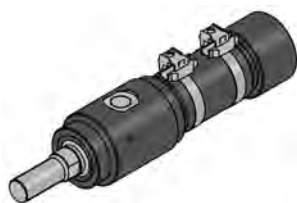

Befestigungsart 00
Mounting mode 00
Mode de fixation 00

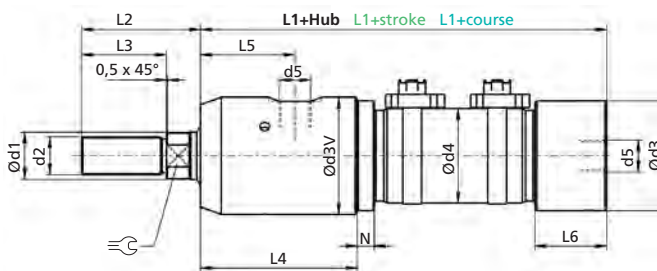

Befestigungsart 01
Mounting mode 01
Mode de fixation 01

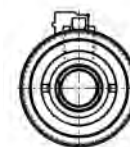
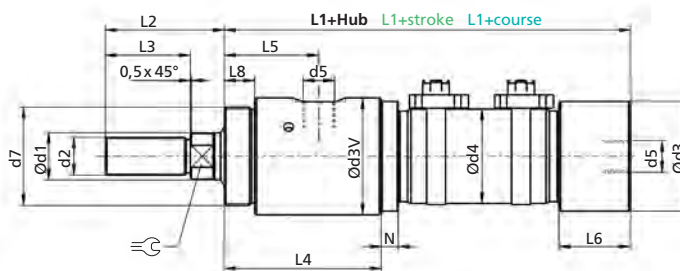

Bestellbezeichnung (Beispiel)
Order specification (example)
Référence de commande (exemple)

MHZ 160 .32 / 20. 00. 201. 100. OM

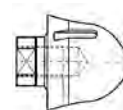

Innengewinde
Internal thread
Filetage intérieur



Anschluss seitlich
Side-mounted oil ports
Raccord latéral

Kolben Ø Piston Ø Ø Piston	Stangen Ø (d1) Rod Ø (d1) Ø Tige (d1)	Befestigungsart Mounting mode Mode de fixation	Funktionsart Operation mode Mode de fonctionnement				Hub Stroke Course	Option Option Option	d2	d3	d3V 00, 01 001	d4	d5	d7	d12	d13 ¹⁷	d14					
			201	204	206	208																
25	16	00	01	001	201	204	206	208	Nach Kundenwunsch To customer specifications À la demande du client	V	M12	45	47	47	30	G 1/4"	M38x1,5	35	24	M6		
32	20	00	01	001	201	204	206	208			E	M16	47	52	52	40	G 3/8"	M42x1,5	42	31	M6	
40	25	00	01	001	201	204	206	208				M1	M20x1,5	58	62	65	50	G 3/8"	M52x2	54	38	M8
50	32	00	01	001	201	204	206	208					M24x1,5	72	72	80	60	G 1/2"	M60x2	67	50	M8
63	40	00	01	001	201	204	206	208				T	M30x1,5	90	90	100	75	G 1/2"	M76x2	80	60	M10

Technische Änderungen vorbehalten
Subject to change without notice
Sous réserve de modifications

Maße in mm
Dimensions in mm
Dimensions en mm

Berechnungsgrundlage siehe ahp informiert
Calculation based on "Information from AHP"
Base de calcul, voir « AHP vous informe »

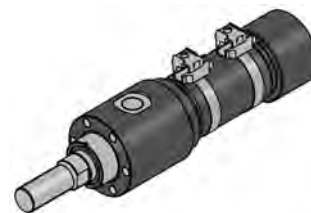

Befestigungsart 001
Mounting mode 001
Mode de fixation 001

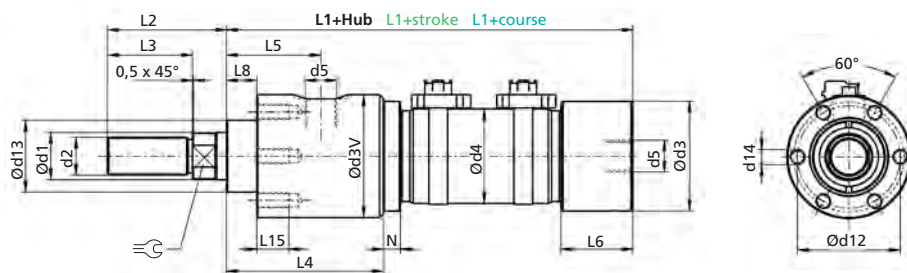

L1		L2	L3	L4	L5	L6		L8	L15	N	
201 206	204 208					201 206	204 208				
148	148	41	30	73	41	35	35	11	12	8	13
156	156	50	35	77	44	38	38	14	11	8	17
165	165	63	45	83	50	38	38	16	17	9	21
178	178	65	45	89	53	43	43	20	18	11	26
228	238	75	55	118	70	50	60	25	20	11	32